

Assembly Instructions

You have your fittings in place, and tools at the ready, so let's begin

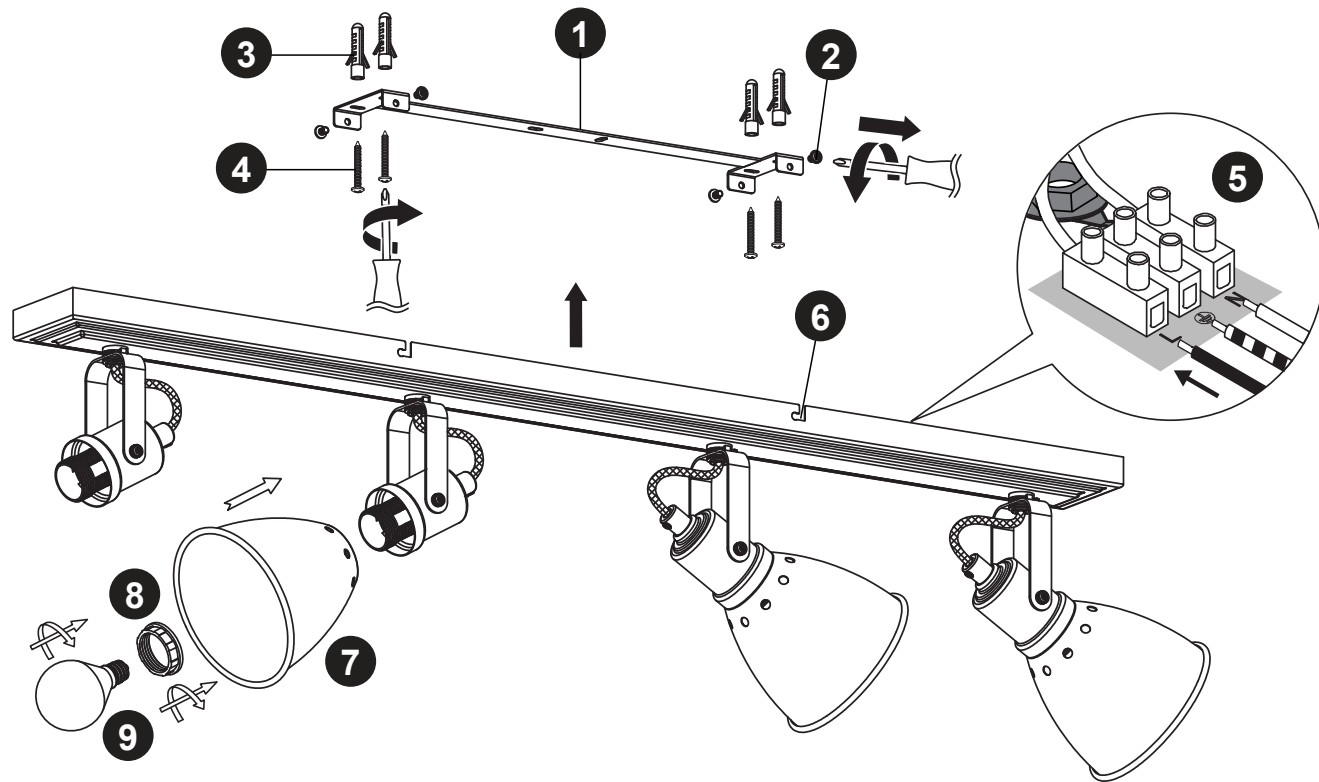

1. Decide on the position of the light fitting or remove existing light fitting. Note the position of the electrical connections, and ensure there is a solid mounting surface, preferably a wooden joist or joist bridge, to support the weight of the light fitting.
2. Remove the mounting bracket (1) from the ceiling cup by loosening the four side screws (2).
3. Using the mounting bracket as a template, mark the position of the mounting holes. Taking care to avoid damaging concealed wires and pipes, drill holes and fit supplied wall plugs (3) (suitable for masonry only - for other surfaces use appropriate fixings).
4. Secure the mounting bracket to the ceiling with appropriate screw fixings (4).
5. Support your fitting and connect the house wiring to the terminal block (5). **NOTE: This is a Class I fitting and must be earthed.** See Wiring Details.
6. Refit the ceiling cup to the bracket. This product has "L" shaped fixing holes to allow easy fixing to the mounting bracket. Locate the "L" slots (6) around the small screws (2) on the mounting bracket (1). Slide the ceiling cup to attach the product to the strap. Tighten the screws to secure. Take care not to trap any wiring.
7. To fit the shades (7), first remove the shade rings (8) from the threaded lampholders. Place the shades over the lampholders and refit the shade rings. Secure in place.
8. Fit the bulbs (9). 4 x Max. 6W LED E14 Golf. **NOTE: Never fit bulbs of a higher wattage than those specified on the label (as this may cause overheating and damage the fitting).**
9. Turn on the power and test.

NOTE: The angle of the shades can be adjusted to the appropriate angle as needed.

DEAR CUSTOMER



Thank you for purchasing your new light fitting from Dunelm.

We put a lot of effort into sourcing and supplying great products, so they are:

- Easy to assemble
- Produced using durable, quality materials

If for any reason you are unhappy with this product, please don't hesitate to contact us on **0845 1 65 65 65** where our customer services team will be happy to help.

The next step...

There is no need to feel daunted by the number of parts and fittings in front of you, as we have compiled this straight forward, step-by-step guide to make sure that assembling your fitting is as easy as 1, 2, 3.

Before you begin, we advise that you check that you have everything you need to get started. A full list of components can be found on page 3 of this manual.

TOP TIP

Find a space to lay the fitting and fixtures out before you begin, and familiarise yourself with the parts.

Ready...?

You are nearly ready to begin, but before you do, make sure you take the time to read through and fully understand our SAFETY AND CARE ADVICE detailed on page 2 of this manual.

We hope you enjoy your light for years to come.

The Dunelm Team

Finally, we hope you enjoy your light for many years to come and thanks again for your purchase.



Safety and Care Advice

IMPORTANT - The first step you need to take is to ensure your safety! Please take the time to read and understand these instructions before assembling your light, and retain for future reference.

- This product is only suitable for connection to a 240V~50Hz supply in accordance with current IEE wiring regulations. It should be installed in accordance with local building regulations and is for indoor use only. It is not suitable for a bathroom location.
- Before installing your light fitting always switch off the mains supply and remove the appropriate fuse or switch off the appropriate circuit breaker before commencing installation.
- This is a Class 1 product and must be earthed. The terminal blocks are supplied according to requirements of the fitting.
- Never fit bulbs of a higher wattage than those specified on the label, as these may cause overheating and damage the fitting.
- This product is suitable for use with a dimmer switch, when used with dimmable bulbs.
- If you are in any doubt about your competence please consult a qualified electrician.
- If any modification is made it will invalidate the warranty and may render the product unsafe.
- Keep children and animals away from the assembly area.
- This fitting contains small parts that could cause choking if swallowed.
- Ensure that all packaging is disposed of carefully and responsibly.

Care and Maintenance Advice

In order to prevent damage or wear to your fitting, take care to ensure the following:

Allow 10 minutes to cool before replacing, adjusting or cleaning.
Clean with a dry cloth only. In order to preserve the finish, do not use liquid or abrasive cleaners on this product.
Our packaging is recyclable, please recycle where facilities exist.

Waste electrical products should not be disposed of with household waste. Please recycle where facilities exist. Check with your Local Authority or retailer for recycling advice.

We're happy to recycle your old light for free. Simply bring it to store within 28 days of purchase of your new light, with your receipt, and we'll make sure your old light stays out of landfill.

Component Parts

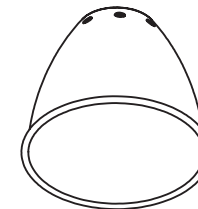
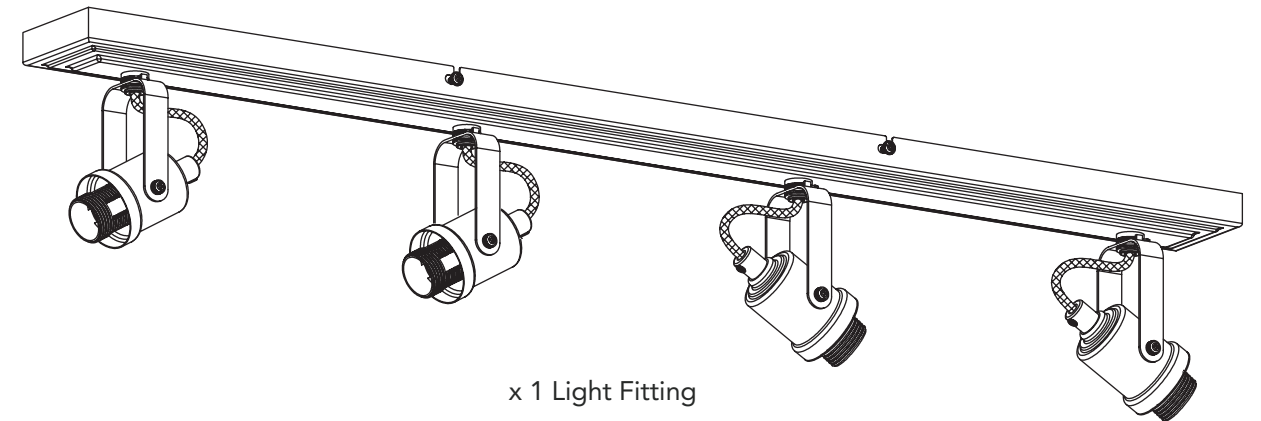

x 4 Shades



x 4 Shade Rings
(fitted)

Component Fittings

A



Screws x 4

B



Wall plugs x 4

Tools Required

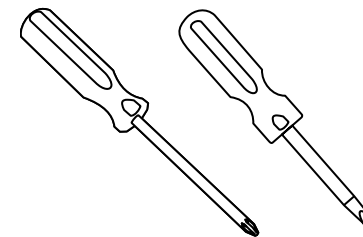

Cross-head and Flat screwdrivers

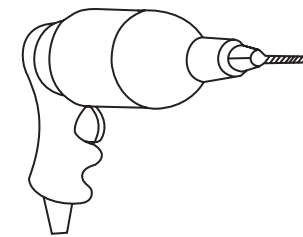

Electrical drill

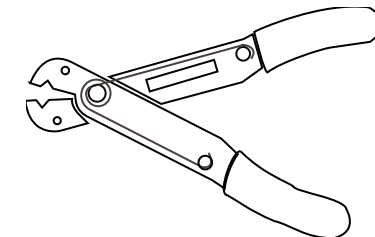

Wire strippers



Electrical insulation tape