

Thank you for purchasing this light fitting. Please read the instructions carefully before use to ensure safe and satisfactory operation of this product. Please keep these instructions for future reference.

Warnings!

This is a Class II product and must NOT be earthed. This product is suitable for indoor use only and is not suitable for a bathroom or outdoor location. Please read these instructions carefully before commencing any work. Your lamp has been packaged as separate parts to prevent damage during transit. When manoeuvring or assembling this product, it must be lifted from the bottom section. Under no circumstances must this table lamp be covered with any material as this could pose a safety hazard. It must be used on a stable, flat surface. The lamp must be protected by a 3 amp fuse in the mains plug. If you are in any doubt, please consult a qualified electrician. For your safety, always switch off the supply before cleaning or changing the bulb. If the mains cable becomes damaged it must only be replaced by a technically competent, qualified person. Always use correct type and wattage bulb. Never exceed the wattage stated. This product contains delicate parts – be careful during handling and maintenance to avoid breakage.

Do not attempt to plug in or use this product until it has been fully assembled.
Disconnect from mains during assembly or maintenance.

Step 1

Carefully unpack your lamp, and place on a stable, flat surface.

Step 2

Fit the bulb (1). Max. 6W LED E14 Golf Filament. **NOTE: Never fit bulbs of a higher wattage than those specified on the label (as these may cause overheating and damage the fitting).**

Step 3

Fit the glass shade (2) by locating over the lampholder and removing and refitting the three shade fixing screws (3). Tighten the screws carefully until the shade is secured - take care not to overtighten. Due to the handmade glass shades, some variance in thickness can occur.

Step 4

Your table lamp is now ready to use. Switch on using the toggle switch on the base (4).

Note: The position of the shade can be adjusted by partially loosening the thumb screw in the join of the shade and arm (5).

If your lamp will not illuminate, please check the bulb, the 3 amp fuse in the plug and ultimately check the relevant fuse in your fuse box. If unsuccessful please contact our customer service team.

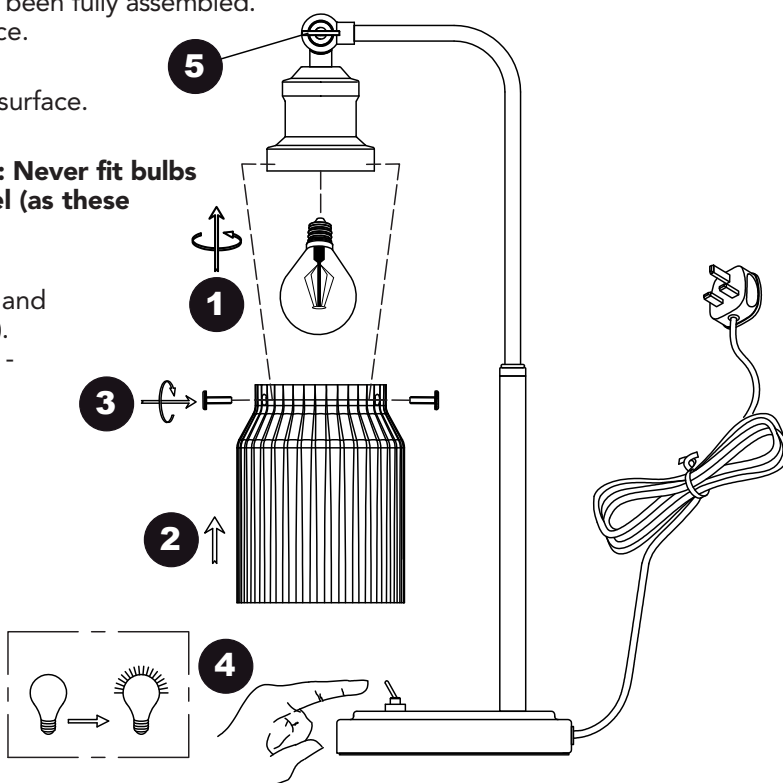



Care and cleaning

Finish - We recommend cleaning with a soft dry cloth. Do not use abrasive materials as these will damage the finish.

Glass parts - Remove and wash in warm water or just use a damp cloth. Do not use abrasive materials as these will damage the finish. Take care when handling glass parts to avoid damage or injury.

Our packaging is recyclable, please recycle where facilities exist.

 Waste electrical products should not be disposed of with household waste. Please recycle where facilities exist.
 Check with your Local Authority or retailer for recycling advice.

We're happy to recycle your old light for free. Simply bring it to store within 28 days of purchase of your new light, with your receipt, and we'll make sure your old light stays out of landfill.

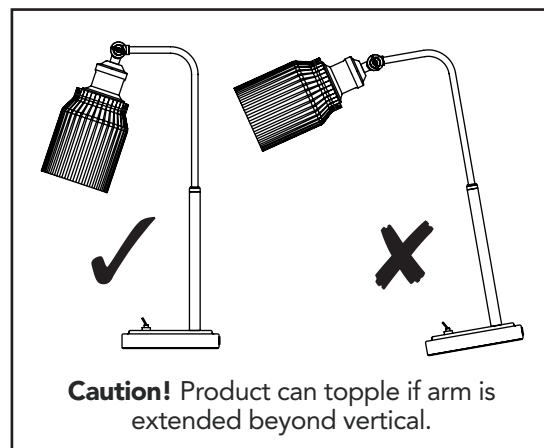

dunelm.com

Manufactured in China for
Dunelm (Soft Furnishings) Ltd. LE7 1AD
& Dunelm (Soft Furnishings)
Londonderry Ltd. BT48 8QN