

Thank you for purchasing this light fitting. Please read the instructions carefully before use to ensure safe and satisfactory operation of this product. Please keep these instructions for future reference.

Warnings!

This is a Class II product and must NOT be earthed. This product is suitable for indoor use only and is not suitable for a bathroom or outdoor location. Please read these instructions carefully before commencing any work. Your lamp has been packaged as separate parts to prevent damage during transit. When manoeuvring or assembling this product, it must be lifted from the bottom section. Under no circumstances must this floor lamp be covered with any material as this could pose a safety hazard. It must be used on a stable, flat surface. The lamp must be protected by a 3 amp fuse in the mains plug. If you are in any doubt, please consult a qualified electrician. For your safety, always switch off the supply before cleaning or changing the bulb. If the mains cable becomes damaged it must only be replaced by a technically competent, qualified person. Always use correct type and wattage bulb. Never exceed the wattage stated. This product contains delicate parts – be careful during handling and maintenance to avoid breakage.

Do not attempt to plug in or use this product until it has been fully assembled. Disconnect from mains during assembly or maintenance.

Step 1

Carefully remove all packaging from the base section, central tubes, top section and shades and place on a stable, flat surface. Remove protective plastic end-caps from the tubes **(1)**.

Step 2

Screw tube **(3)** onto the lampholder section **(2)** in a clockwise direction. Take care not to trap the cable or cross the threads. Then screw tube **(4)** onto tube **(3)** in the same way.

Step 3

Lay the product down and gently pull any excess cable through from the bottom tube and then out through the side of the base. Turn the completed assembly anticlockwise approximately 6 times. (Turning the tubes anticlockwise first ensures that the cable will straighten when the tubes are fully assembled).

Step 4

Screw the assembly onto the base. Make sure the shade is facing forward over the base **(see Fig. 1)**. The stem position can be adjusted by loosening and re-tightening the nut under the base using the supplied spanner **(5)**. Stand the product upright and check the tightness of the joints.

Step 5

Remove the rubber washer **(8)** from the lampholder and fit the bulb **(6)**. Max. 10W LED E27 GLS. **NOTE: Never fit bulbs of a higher wattage than those specified on the label (as this may cause overheating and damage the fitting).**

Step 6

To fit the glass shades first rotate the outer shade **(7)** 180°. Place the rubber washer **(8)** inside the shade followed by the inner shade **(9)** **see Fig. 2**. While carefully holding onto both shades, flip the assembly.

Step 7

Support both shades and turn the inner shade in a clockwise direction to attach to the lamp **see Fig. 3**. This may be easier to do with the help of an assistant. Take care not to cross the threads. **Please note:** The glass is very fragile. Take extra care to tighten with light pressure in order to avoid breakage to the shades.

Changing the bulb: Support and hold both shades and rotate the inner shade anticlockwise to remove. Remove and refit the bulb and repeat step 7. **Fig. 4**.

Step 8

Your floor lamp is now ready to use. Switch on using the foot switch.

If your lamp will not illuminate, please check the bulb, the 3 amp fuse in the plug and ultimately check the relevant fuse in your fuse box. If unsuccessful please contact our customer service team.

Care and cleaning

Finish - We recommend cleaning with a soft dry cloth. Do not use abrasive materials as these will damage the finish.

Glass parts - Remove and wash in warm water or just use a damp cloth. Do not use abrasive materials as these will damage the finish. Take care when handling glass parts to avoid damage or injury.

Our packaging is recyclable, please recycle where facilities exist.

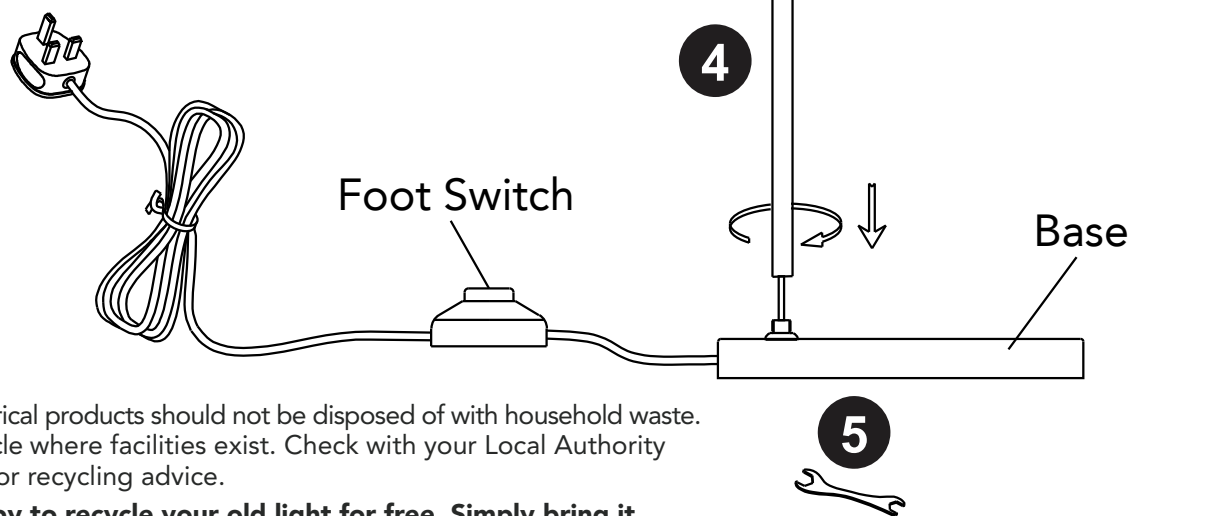
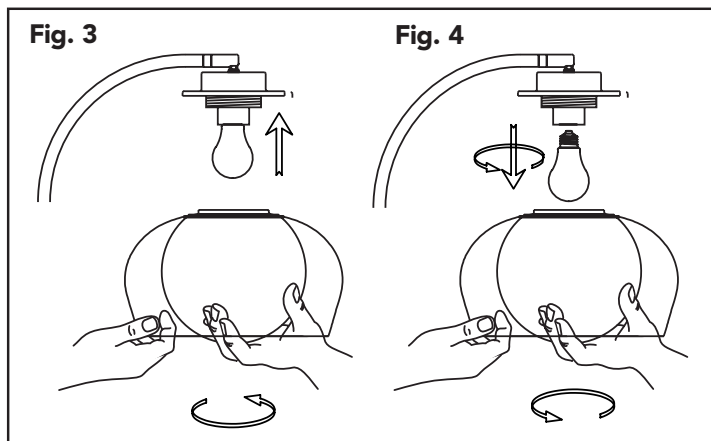
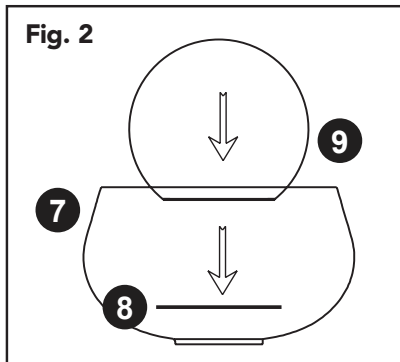
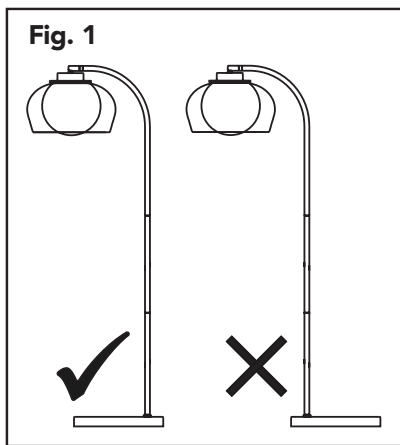

 Waste electrical products should not be disposed of with household waste. Please recycle where facilities exist. Check with your Local Authority or retailer for recycling advice.

We're happy to recycle your old light for free. Simply bring it to store within 28 days of purchase of your new light, with your receipt, and we'll make sure your old light stays out of landfill.

dunelm.com

Manufactured in China for
Dunelm (Soft Furnishings) Ltd. LE7 1AD
& Dunelm (Soft Furnishings)
Londonderry Ltd. BT48 8QN

