

Thank you for purchasing this light fitting. Please read the instructions carefully before use to ensure safe and satisfactory operation of this product. Please keep these instructions for future reference.

## Warnings!

-  This fitting is a Class II, double insulated product. It does not require an Earth, and Live or Neutral must not be connected to Earth.
- Please read these instructions carefully before commencing any work. It is recommended that this fitting is installed by a qualified electrician. Install in accordance with the IEE Wiring regulations and the Building Regulations.
- To prevent electrocution switch off at mains supply before installing or maintaining this fitting.
- Ensure other persons cannot restore the electrical supply without your knowledge. If you are in any doubt, please consult a qualified electrician.
- This light fitting should be connected to a 5 amp fused circuit.
- If replacing an existing fitting, make a note of the connections.
- Always use the correct type and wattage bulb. Never exceed the wattage stated. When changing a bulb, always switch off at the mains and allow the old bulb to cool down before handling. Dispose of used bulbs carefully.
- This product is suitable with a dimmer switch when used with dimmable bulbs.
- This product is rated IP44. This product is suitable for indoor use only.
- If any modification is made it will invalidate the warranty and may render the product unsafe.
- This product contains delicate parts – be careful during handling and maintenance to avoid breakage.
- Keep children and animals away from the assembly area.
- Keep all plastic wrapping materials away from children to avoid danger of suffocation.
- Ensure that all packaging is disposed of carefully and responsibly.

## Fixing Instructions

Make sure you have the following items which are required to install this light fitting:  
Small electrical screwdriver, cross head screwdriver & insulation tape.

### Step 1

Decide on the position of the light fitting or remove existing light fitting. Note the position of the electrical connections, and ensure there is a solid mounting surface, preferably a wooden joist or joist bridge to support the weight of the light fitting.

### Installation

This product has special protection against the ingress of moisture and is IP44 rated.  
This product is suitable for use in Zone 2 and outside Zones of a bathroom. If fitting in a bathroom a 30mA RCD must be fitted in accordance with IEE wiring regulations.

### Step 2

Remove the mounting bracket **(1)** from the product by undoing the two side screws **(2)** and retain for reuse later. Use the mounting bracket as a template to mark the screw holes. Drill holes and fit supplied wall plugs **(3)** (suitable for masonry only - for other surfaces use appropriate fixings). Take care not to damage any wiring or pipes when drilling the holes. Secure the mounting bracket to the ceiling with appropriate screw fixings **(4)**.

### Step 3

Having identified the household wiring from your existing light fitting, connect to the connection block **(5)** inside the product in the following way:

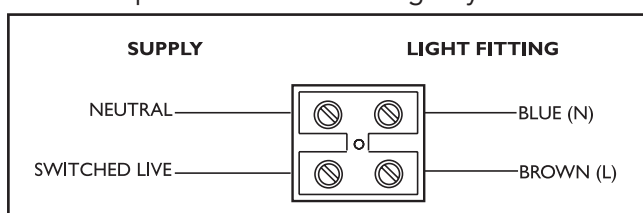

### Step 4

Refit the fitting onto the ceiling using the screws removed in step 2 and tighten the screws to secure. Take care not to trap any wiring.

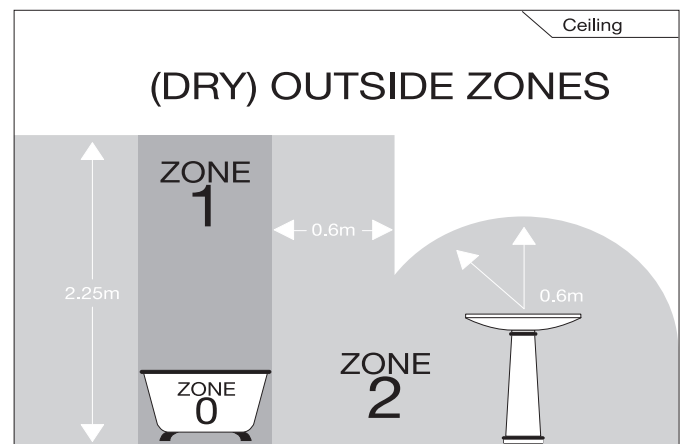

## Check that...

- You have correctly identified the house wires.
- The connections are tight.
- No loose strands have been left out of the connection block.
- Make sure the lid of the connection box is securely fixed to maintain moisture protection.

## Step 5

There are two rubber washers fitted onto the lampholder. Remove only one but keep the second in place (6) and fit the bulb (7). Max. 6W LED E14 Candle. **NOTE: Never fit bulbs of a higher wattage than those specified on the label (as this may cause overheating and damage the fitting).**

## Step 6

To fit the glass shades first rotate the outer shade (8) 180°. Place the second rubber washer (9) inside the shade followed by the inner shade (10) see Fig. 1. While carefully holding onto both shades, flip the assembly.

## Step 7

Attach both shades to the lampholder by supporting and turning the inner shade in a clockwise direction see Fig. 2. Take care not to cross the thread and make sure the washers are securely in place. This is essential to ensure the product remains waterproof. **Please note:** The glass is very fragile. Take extra care to tighten with light pressure in order to avoid breakage to the shade.

**Changing the bulb:** Support and hold the inner shade and rotate anticlockwise to remove both shades. Remove and refit the new bulb and repeat step 7. Fig. 3.

## Step 8

Replace fuse or circuit breaker and switch on to test. Your light is now ready for use.

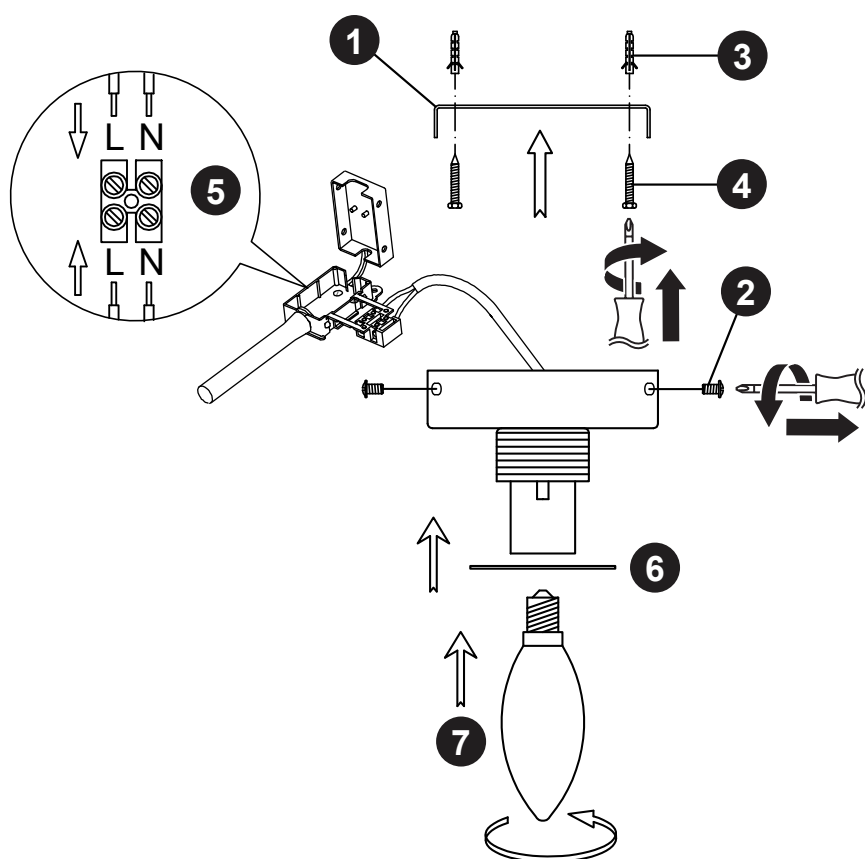

Fig. 1

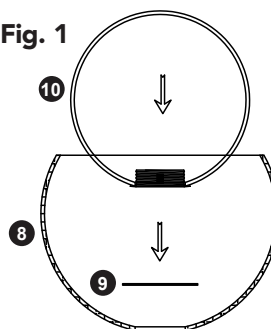

Fig. 2

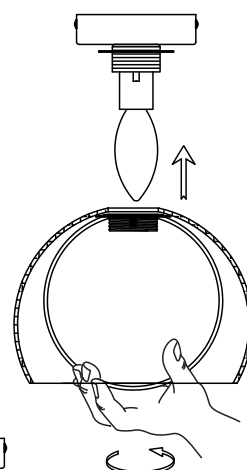
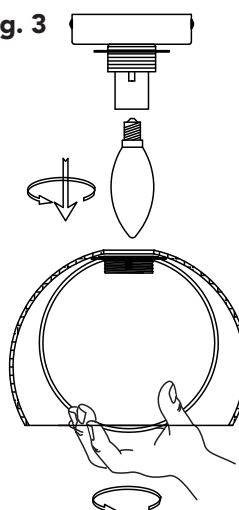

Fig. 3



## Care and cleaning

**Finish** - We recommend cleaning with a soft dry cloth. Do not use abrasive materials as these will damage the finish.

**Glass parts** - Remove and wash in warm water or just use a damp cloth. Do not use abrasive materials as these will damage the finish. Take care when handling glass parts to avoid damage or injury.

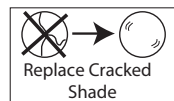

Do not use this product if the shade is cracked or damaged.  
Do not use the product without the shade attached.

Our packaging is recyclable, please recycle where facilities exist.

Waste electrical products should not be disposed of with household waste. Please recycle where facilities exist.  
Check with your Local Authority or retailer for recycling advice.

**— We're happy to recycle your old light for free. Simply bring it to store within 28 days of purchase of your new light, with your receipt, and we'll make sure your old light stays out of landfill.**

**dunelm.com**

Manufactured in China for  
Dunelm (Soft Furnishings) Ltd. LE7 1AD  
& Dunelm (Soft Furnishings)  
Londonderry Ltd. BT48 8QN

