

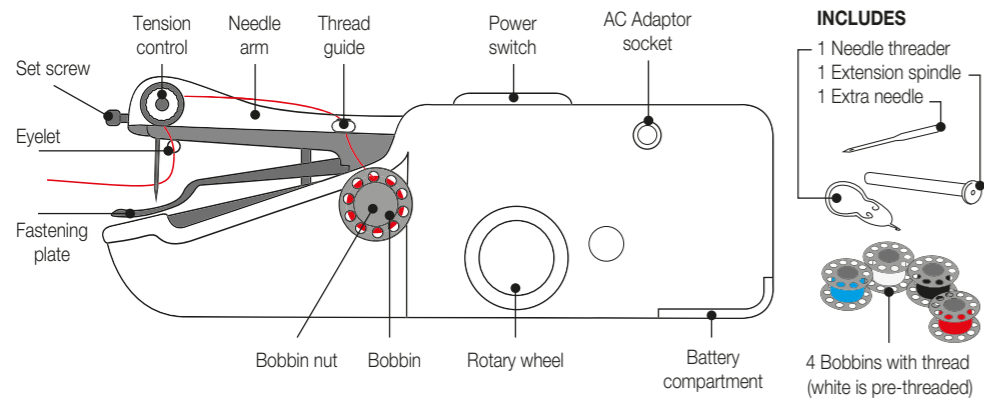

Thank you for buying Magic Stitch from JML.
Please read these instructions carefully before first use and retain for future reference.

Your Magic Stitch



Warnings

This is not a toy. Keep this away from children.
Take care to fit batteries correctly.
Always make sure the battery compartment is secure.
If not in use for long periods of time, please remove the batteries.

CAUTION: Needle is sharp. Use care working with needle to avoid injury. Take extreme care not to accidentally turn Magic Stitch on while handling it. Keep Magic Stitch on a stable, flat surface while changing threads, spools, needles etc and keep hands away from the power button. Alternatively, to be extra sure, remove batteries between sewing sessions to avoid accidental injury.

User Instructions - Operating instructions (pre-threaded)

How to use Magic Stitch Operating instructions (pre-threaded)

Note: For best use, operate Magic Stitch for 10-15 seconds at a time, pausing for a few seconds between uses.

1. Raise the needle arm to the highest position by turning the rotary wheel so that the point of the needle is around 4mm clear of the fastening plate. (see Fig. 1)
Note: The rotary wheel can be turned in either direction.

2. Grip the body of the Magic Stitch with one hand, near the needle end, and use a finger to pull the fastening plate up towards the needle arm by the metal tab that extends from one side (taking care not to press down on the needle arm or accidentally turning the Magic Stitch on with the back of your hand). With the other hand, place the cloth you want to work on under the lifted fastening plate. (see Fig. 2)

WARNING: do not force any fabric underneath the fastening plate and needle. This could damage the needle.

3. Pull at least 2 inches of thread through the needle, from back to front, prior to starting to sew.
4. Hold the Magic Stitch with right hand, using your thumb to operate the power switch and supporting it with your fingers underneath, away from the needle end. (see Fig. 3)

5. Push the power switch forward with your thumb to operate. The machine will feed the cloth to the left in proper tension automatically. Use left hand to hold the cloth and control the direction (do not rush the machine). When wider stitches are required, pull cloth to the left a little faster while you continue sewing. Follow the cloth fastening plate to ensure straight stitching (see Fig. 4). To stop stitching, slide the power switch back to the original position.

6. When you have finished sewing and the power is off, regardless of what position the needle is in, use the rotary wheel to manually lower the needle and raise it back to its highest position. This will close the final stitch and stop it from unraveling while you tie it off. (see Fig. 5)

7. Before removing the cloth, using the back of a pair of scissors pull around 3 inches of thread, to be used as a 'tail' for tying off in a knot, and then cut the thread near the needle. (see Fig. 6 & 7)

8. Lift up the fastening plate and take the cloth to the left. (see Fig. 8)
Take care not to snag the sewing as you go. Remove any loose lengths of thread that were beneath the needle. This should leave you with a sewn section of fabric and a 3" tail for the knot.
Note: If fabric gets stuck, turn the rotary wheel down to the lowest point and then back up again.

Note: If fabric gets stuck, turn the rotary wheel down to the lowest point and then back up again.

9. To tie off your sewing: (see Fig. 9) Firstly, ensure that the 3" tail of thread is on the back side of the cloth. This will prevent the stitching from coming undone. If the thread tail isn't already on the back, turn to the back side of the cloth and find the last loop stitched. Pull this gently to feed the thread tail from the front through to the back.

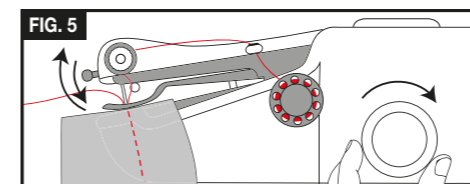
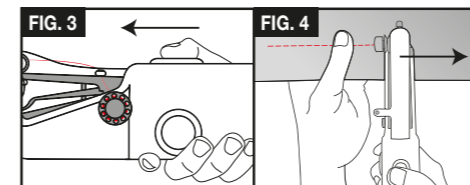
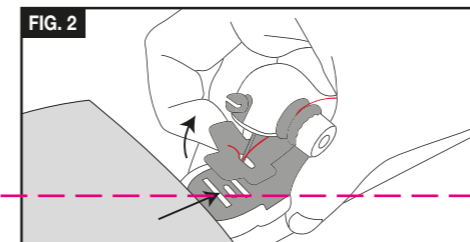
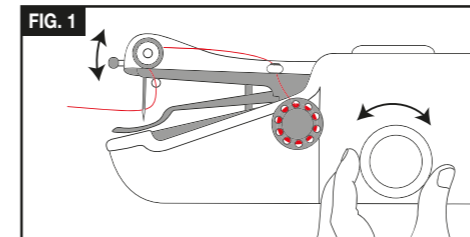

User Instructions - Operating instructions (pre-threaded) continued

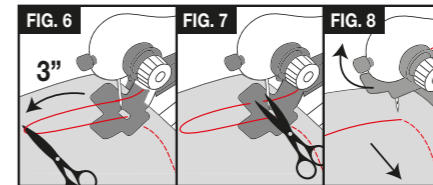

- a. Turn to back side of the cloth with the 3" tail of thread showing.
- b. Push the threader through/under the last stitch next to the 'tail'.
- c. Thread the first inch of the 'tail' into the threader.
- d. Pull it back through, leaving that inch of thread on one side of the last stitch, and a loop of 2 inches on the other.
- e. Remove threader and pass the inch of tail back through the loop.
- f. Pull it until tight and trim any excess thread.

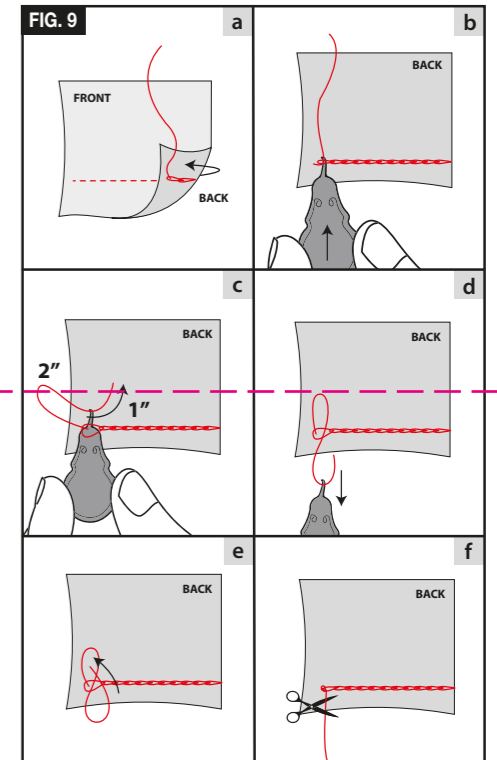

User Instructions - how to thread

How to thread Magic Stitch

Note: Thread should flow from the back of the bobbin or spool and travel upwards through the thread guide. Spring must be in place before installing bobbin. (see Fig. 10)

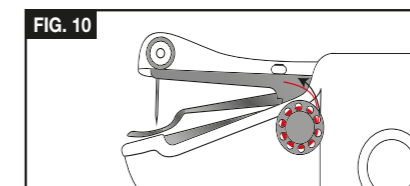

1. Pass the thread through the thread guide on the needle arm. (see Fig. 11)

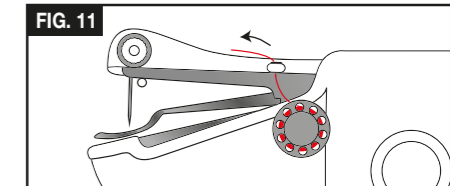

2. Pass the thread over (not wrapped around) the tension guide, making sure that it is pinched between the two metal discs. (see Fig. 12)

User Instructions - how to thread continued

3. Pass the thread through the eyelet on the underside of the needle arm just behind the needle. (see Fig. 13)

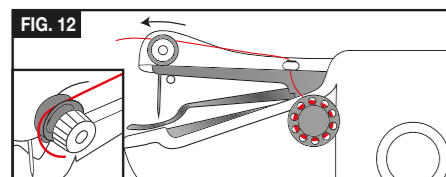

4. Slide the threader through the eye of the needle from the front until the wire loop appears on the other side at the back of the needle and opens again. Pass the thread through wire loop of the threader and pull the threader back through the needle, bringing the thread with it and leaving your needle threaded from the back and out of the front. Lastly, pass the thread through the fastening plate. Then pull about 2 inches of thread through before sewing. (see Fig. 14, 15 & 16)

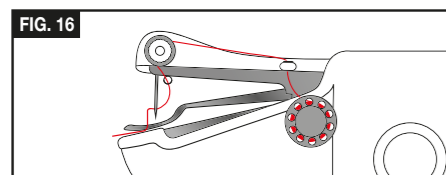
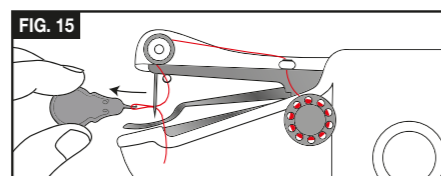
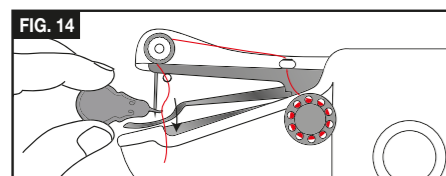
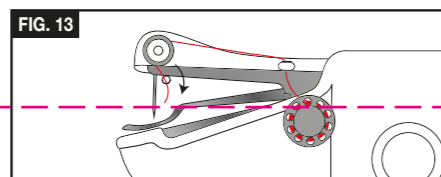

To install a large thread spool (see Fig. 19)

1. Using your nails under the head of the bobbin nut, gently pull it free and remove the spool and spring.
2. Place your large spool onto the extension spindle and then add the spring so that it will sit nearest the Magic Stitch when in place.
3. Insert extension spindle into Magic Stitch where the bobbin nut was inserted.
4. Thread Magic Stitch as described above.

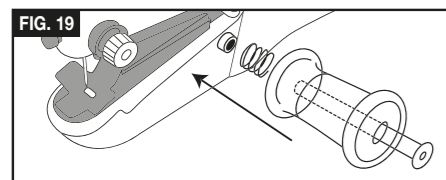

Adjusting thread tension

Note: Always test on a small piece of fabric first.

1. If stitching is too tight, turn tension control slightly to the left. (see Fig. 17)
2. If stitching is too loose, turn tension control slightly to the right. (see Fig. 18)

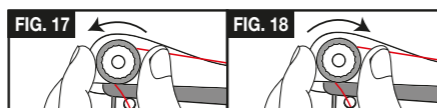

Care and Maintenance:

- When not in use, store your Magic Stitch in a cool, dry place.
- Every few uses, clean the machine. This will ensure it is free of dirt and debris which may damage the machine. Use a clean, fluffy brush to do this, especially focusing on the bobbin, fastening plate, and below the fastening plate. This will prolong the life of the machine.

User Instructions - how to thread continued

Troubleshooting Guide:

Problem	Potential Solution
Sewing Machine gets stuck	Adjust the tension. If the issue keeps occurring, replace the needle as it may be damaged.
Needle has bent or snapped	Replace the needle. Do not attempt to sew with a damaged needle as this could damage the machine.
Missing stitches	Adjust the tension. Lower the needle position. If the issue keeps occurring, replace the needle as it may be damaged.
Stitches aren't being formed	Check that the machine has been threaded correctly. Ensure that the bobbin area is free from lint and debris. Check that the needle is facing the correct way. Ensure that the thread has been pulled through the tension plate.
Stitches unravelling	Ensure that the stitches have been tied off correctly as per the instructions in Step 9.
Thread knotting underneath the fabric	Check that the thread is in between the tension plates.

To replace batteries (see Fig. 21 & 22)

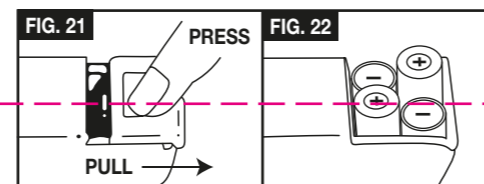

To replace needle

Loosen the set screw with a screwdriver and take out the old needle. Always use a #14 style DHx 1 sewing needle. Needle must be installed with flat side on the shank facing the front of Magic Stitch. (see Fig. 20) Ensure the needle is inserted all the way in. If stitching is inconsistent, lower the needle slightly.

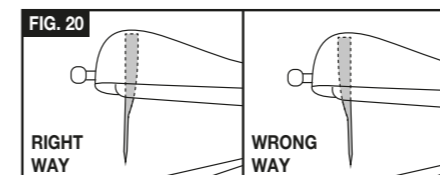

To really make the most of your sewing experience, why not purchase the sewing kit that accompanies your Magic Stitch, with a host of additional threads and accessories, from our website: JMLdirect.com

SCAN TO WATCH



SEE HOW EASY MAGIC STITCH IS TO USE WITH OUR 'HOW TO' VIDEO GUIDE

<https://www.jmldirect.com/blog/sewing-machine-day-how-to-use-your-magic-stitch-portable-sewing-machine>

Technical

Batteries: 4 x 1.5V AA Alkaline (not included). AC/DC Adaptor (not included). Adaptor must be 6V 600mA. Adaptor must use plug with 1/8" / 3.5mm diameter. Plugging an adapter into a portable that has different ratings could damage the portable adaptor and/or the Magic Stitch.

Guarantee

This product is guaranteed for one year against all defects of workmanship and materials. This guarantee does not affect your statutory rights. For refunds and replacements, please return the item to the retailer where you initially made the purchase. You will be required to provide proof of purchase. If you have any problems or queries about this product, please contact JML customer services.



Distributed by:

JML, Unit 1 Eastside, Port of Tyne, South Shields, UK, NE33 5SP.
JML GmbH, Rheinstraße 3, 63225 Langen, Germany.
Customer Services: UK: 0800 031 9020 (Freephone). ROI: 041-978 0003 (Local rate)
Email: info@JMLgroup.co.uk. Web: www.JMLdirect.com
©JohnMillsLtd/HL/11.23/2069/F. Made in China

