

# DUNELM WOOD EFFECT VENETIAN BLIND

## Fitting Instructions

Please keep for future reference

### Tools required

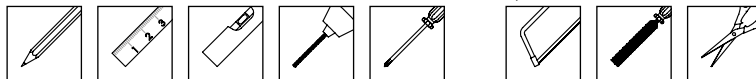

## WARNING

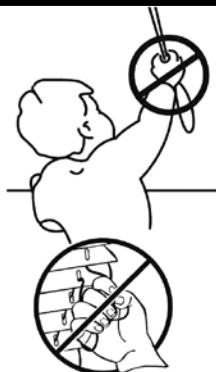

Young children can be strangled by loops in pull cords, chains, tapes and inner cords that operate the product.

To avoid strangulation and entanglement, keep cords out of the reach of young children.

Cords may become wrapped around a child's neck.

Move beds, cots and furniture away from window covering cords.

Do not tie cords together.

Make sure cords do not twist and create a loop.

**PERSONS IN CHARGE OF CHILDREN ARE ULTIMATELY RESPONSIBLE FOR FOLLOWING THE SAFETY INSTRUCTIONS PROVIDED BY THE MANUFACTURER AND TO USE ANY SAFETY DEVICE SUPPLIED.**

The installation can be completed by non-professionals.

Please note: These blinds are not suitable for use in rooms where the temperature exceeds 50°C for a sustained period. Please read these instructions carefully and check the contents of the pack before attempting to assemble and fit this product.

### Pack Contents

- 1 x Blind
- 2 x End Brackets
- 2 x Hold Down Brackets
- 1 x Valance with Fixings
- 1 x Screw Pack
- 1 x Tilt Wand
- 1 x Cleat
- Intermediate Support (optional, number dependant on blind width)

Should any component be missing, please call the Customer Care Department on **01543 272605**

### Safety Recommendation

Always use a Step Ladder when working at height.

DO NOT over reach. Always move the Step Ladder so that you are in a safe working position.

DO NOT hold or lean on the blind to support your weight.

We recommend you use two people for installation of a larger blind.

Take care when using power tools, use of a Residual Current Device (RCD) is recommended.

Always use eye protection when drilling. Beware of hidden pipe runs and cables.

No liability will be accepted for damage or injury caused by incorrectly installed or assembled product.

**PLEASE KEEP OUT OF THE REACH OF YOUNG CHILDREN. SMALL PARTS - CHOKING HAZARD.  
PLEASE KEEP THESE INSTRUCTIONS AND THE BATCH CODE ON THE PACKAGING FOR FUTURE REFERENCE IN CASE OF ANY QUERIES.**

Note: Use the correct wall plugs and screws for the type of wall to which you are mounting your blind and cleat. If you are unsure please consult your local builders merchant or DIY store.

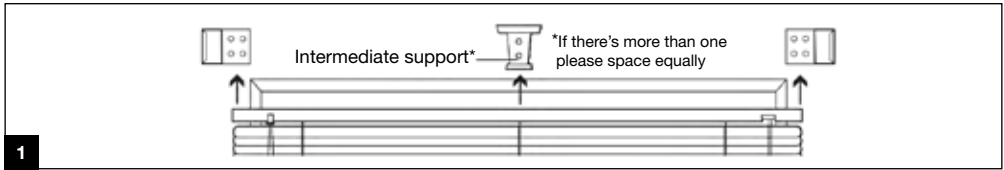

## Fitting the brackets

**Headrails shall not be installed less than 1.5m from the floor.**

1. Lay the blind and components out on the floor.
2. Decide if your blind is to be fitted inside or outside the window recess. Please be aware that the brackets should be installed as per fig. 2 & 3 with the door opening towards the side, away from the blind.
3. If fitting outside the recess, see figs.1 & 2. The blind width should be around 10cm longer on each side of the window. The intermediate support will only be supplied with wider blinds.
4. If the blind is to be fitted within the recess, fit the brackets accordingly (fig.3). The blind can be cut down with a fine tooth saw.
5. If the intermediate support is required to be fitted, follow figs.4 & 5 depending on wall or ceiling mount.

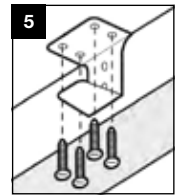
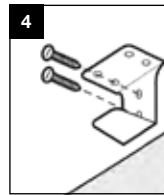
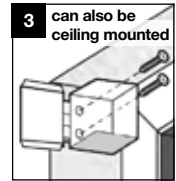
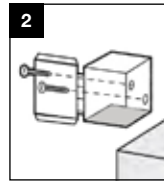

## Reducing the blind width (if required)

1. Measure the distance between the inside faces of the end brackets.
2. Lay the blind flat, measure equal amounts from both ends of the blind and mark a straight cutting line across the headrail, slats and base rail (fig.6).
3. Tighten the slats and base rail together with low adhesive masking tape inside the marked cutting line (fig.7).
4. Remove the end caps from the headrail and base rail.
5. Cut through the headrail, slats and base rail using a fine tooth saw and file any burrs (fig.8).
6. Replace the end caps and remove the masking tape.

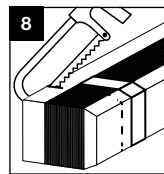
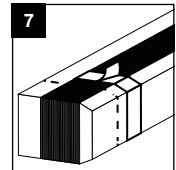
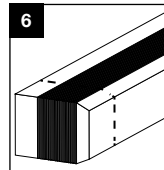

## Fitting the blinds

1. Place the headrail into the mounted brackets, close and secure the bracket covers (fig.9).
2. If the intermediate support is fitted, rest the blind on the support (fig.10).
3. Attach the tilt wand (fig.11).
4. Peel off the backing paper of the velcro patches provided and attach onto the rear of the valance, ensuring they are evenly spread. Align the valance with the blind headrail and press firmly into place (fig.12).

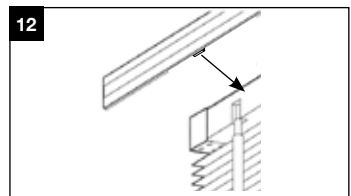
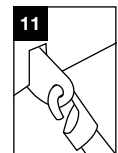
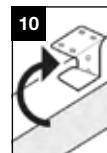
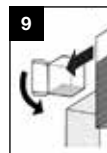

## Positioning the cord stops and reducing the slat stack at the bottom

1. The cord-stops are preinstalled 2.5-5cm from the headrail, they need to be loosened (but do not untie them) and moved down the cord by hand before you can lower the blind (fig.13).
2. Lower the blind to the maximum desired length and lock in place.
3. Push the cord-stops and the loosened knots toward the headrail until the cord-stops are 2.5-5cm below the head rail (fig.14).
4. Hold the cord-stop in place and pull firmly on the pull cord to re-tighten the knot (fig.15).
5. Repeat steps 3 & 4 for the other cord-stops.

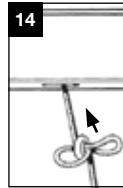
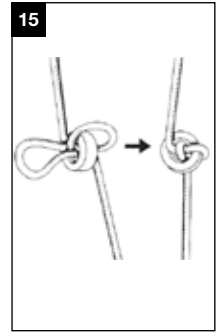
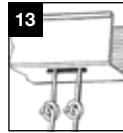

## Reducing the blind drop

1. Measure the drop required.
2. With the blind fully opened and placed on a flat surface, remove the plugs in the bottom rail and untie the knot in the lift cord (fig.16).
3. Remove the base rail and surplus slats.
4. Cut off the excess ladder cord ensuring that at least 25mm surplus remains (fig.17). **DO NOT CUT THE LIFT CORD.**
5. Replace the bottom rail, re-thread the lift cord and re-tie the knot in the end of the lift cord. Tuck the surplus ladder cord into the bottom rail, securing it with the plugs (fig.18).
6. Cut the excess lift cord below the knot.

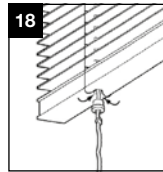
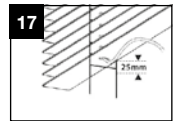
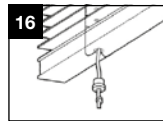

## Fitting the child safety cleat

The child safety cleat (fig.19) is designed to keep loose cords out of young children's reach and avoid the risk of strangulation.

1. The cleat needs to be installed as close to the headrail as possible and, in all cases, not less than 1.5m from the floor.
2. Mark and fix the cleat using correct fixings. Ensure that the fixing is secure.

Check the cords at regular intervals to ensure they have not become tangled and formed a loop.

Each time the blind is operated, the cords should ALWAYS be wrapped around the cleat to ensure that they cannot be reached and that the cord cannot be pulled loose by young children.

Please follow the steps below:

1. Wrap the cord tightly around the cleat in a figure of 8 motion as shown fig.19.
2. When nearing the end of the cord, loop the remaining length over the body of the cleat allowing the minimal amount of cord to drape from the cleat as possible.

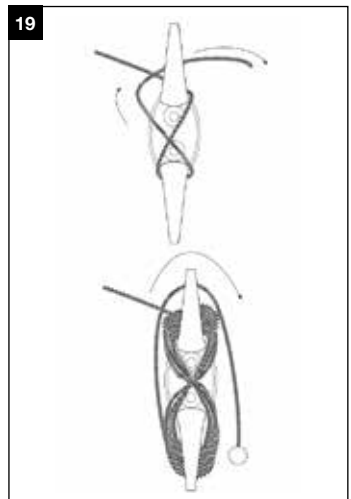

## Installation of the hold down brackets (optional)

These parts can be installed in order to stop the blind moving when the window is open in windy conditions.

1. Lower the blind and mark the position of the hold down brackets at each side. Screw the brackets into position using the short screws (fig.20).
2. The lug on the hold down bracket fits into the hole in the end cap of the bottom rail (fig.21).

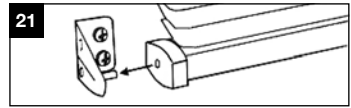
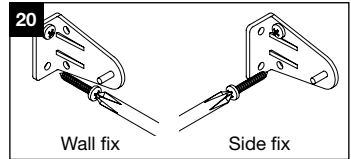

## Operating the blind (fig.22)

Always tilt the slats to the horizontal (open) position before raising or lowering the blind.

To lower the blind (fig.23):

1. Bring the cords across the face of the blind.
2. Gently tug the cords to release the cord lock and allow the cords to slip through your fingers at this angle.
3. At the desired drop put the cords back in the vertical position to re-engage the cord lock.
4. Wrap the cords on the cleat as described in the "Fitting the child safety cleat" section.

To raise the blind (fig.24):

1. Bring the cords across the face of the blind.
2. Pull the cords at this angle and raise the blind.
3. At the desired height put the cords back in the vertical position to re-engage the cord lock.
4. Wrap the cords on the cleat as described in the "Fitting the child safety cleat" section.

To tilt the slats:

1. Rotate the wand to tilt the slats to the desired angle.

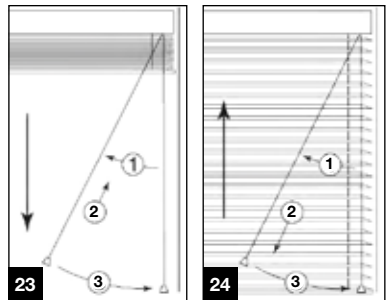
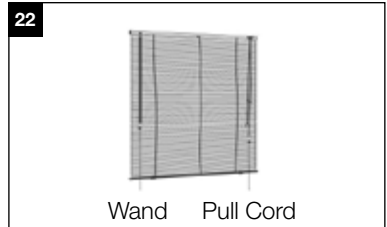

## Top tip

In hot weather it is recommended to keep the blind in a fully lowered position with the slats closed to reduce the risk of the slats bowing

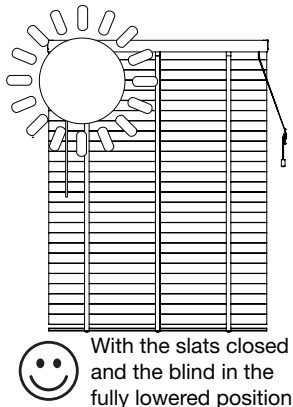
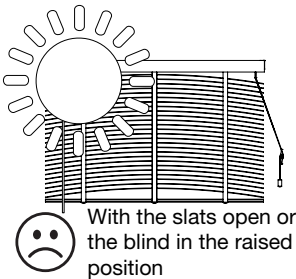

## Care instructions

Use a clean, dry duster or damp cloth to clean the blinds. Stains or spillages can be removed using a mild detergent and lukewarm water.